

Coalinga-Huron Sports Complex

Coalinga, CA

Lighting System

Pole / Fixture Summary						
Pole ID	Pole Height	Mtg Height	Fixture Qty	Luminaire Type	Load	Circuit
A1-A2	60'	60'	2	TLC-LED-1200	2.34 kW	A
		16'	1	TLC-BT-575	0.58 kW	A
A3-A4	60'	60'	2	TLC-LED-1200	2.46 kW	B
B1-B2	70'	70'	6	TLC-LED-1500	8.58 kW	A
		16'	1	TLC-BT-575	0.58 kW	A
B3	60'	60'	4	TLC-LED-1500	6.00 kW	B
		16'	1	TLC-BT-575	0.58 kW	B
B4	60'	60'	4	TLC-LED-1500	5.79 kW	B
		16'	1	TLC-BT-575	0.58 kW	B
C1-C2	60'	60'	4	TLC-LED-1200	4.80 kW	A
		16'	2	TLC-BT-575	1.15 kW	A
C3	60'	60'	3	TLC-LED-1200	3.69 kW	B
		16'	3	TLC-BT-575	1.73 kW	B
11			52		59.32 kW	

Circuit Summary			
Circuit	Description	Load	Fixture Qty
A	Field 1	36.04 kW	32
B	Field 2	23.28 kW	20

Fixture Type Summary							
Type	Source	Wattage	Lumens	L90	L80	L70	Quantity
TLC-LED-1200	LED 5700K - 75 CRI	1170W	136,000	>120,000	>120,000	>120,000	8
TLC-LED-1500	LED 5700K - 75 CRI	1500W	156,100	>120,000	>120,000	>120,000	5
TLC-LED-1200	LED 5700K - 75 CRI	1230W	132,300	>120,000	>120,000	>120,000	11
TLC-LED-1500	LED 5700K - 75 CRI	1430W	160,000	>120,000	>120,000	>120,000	15
TLC-BT-575	LED 5700K - 75 CRI	575W	52,000	>120,000	>120,000	>120,000	13

Light Level Summary

Calculation Grid Summary								
Grid Name	Calculation Metric	Illumination					Circuits	Fixture Qty
		Ave	Min	Max	Max/Min	Ave/Min		
Field 1 (Infield)	Horizontal Illuminance	54.3	42	68	1.61	1.29	A	32
Field 1 (Outfield)	Horizontal Illuminance	31.5	21	47	2.23	1.50	A	32
Field 2 (Infield)	Horizontal Illuminance	51.4	37	66	1.77	1.39	B	20
Field 2 (Outfield)	Horizontal Illuminance	30.8	20	47	2.33	1.54	B	20
Spill @ 150'	Horizontal	0.02	0	0.12	1135.23		A,B	52
Spill @ 150'	Max Candela (by Fixture)	1694	38.7	7472	193.23	43.80	A,B	52
Spill @ 150'	Max Vertical Illuminance Metric	0.05	0	0.29	423.35		A,B	52

From Hometown to Professional

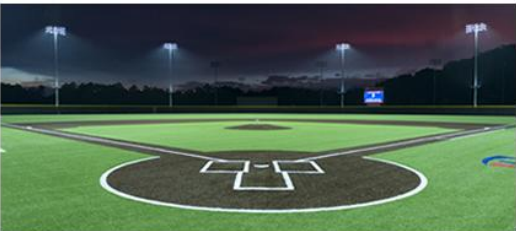

We Make It Happen®

EQUIPMENT LIST FOR AREAS SHOWN								
Pole				Luminaires				
QTY	LOCATION	SIZE	GRADE ELEVATION	MOUNTING HEIGHT	LUMINAIRE TYPE	QTY / POLE	THIS GRID	OTHER GRIDS
2	A3-A4	60'	-	60'	TLC-LED-1200	2	2	0
2	B3-B4	60'	-	15.5'	TLC-BT-575	1	1	0
				60'	TLC-LED-1500	4	4	0
1	C3	60'	-	15.5'	TLC-BT-575	3	3	0
				60'	TLC-LED-1200	3	3	0
5	TOTALS					20	20	0

Coalinga-Huron Sports Complex

Coalinga, CA

GRID SUMMARY	
Name:	Field 2
Size:	225'/225'/225' - basepath 60'
Spacing:	20.0' x 20.0'
Height:	3.0' above grade

ILLUMINATION SUMMARY		
MAINTAINED HORIZONTAL FOOTCANDLES		
	Infield	Outfield
Guaranteed Average:	50	30
Scan Average:	51.35	30.81
Maximum:	66	47
Minimum:	37	20
Avg / Min:	1.37	1.54
Guaranteed Max / Min:	2	2.5
Max / Min:	1.77	2.33
UG (adjacent pts):	1.37	1.73
CU:	0.70	
No. of Points:	25	94
LUMINAIRE INFORMATION		
Applied Circuits:	B	
No. of Luminaires:	20	
Total Load:	23.28 kW	

Guaranteed Performance: The ILLUMINATION described above is guaranteed per your Musco Warranty document and includes a 0.95 dirt depreciation factor.

Field Measurements: Individual field measurements may vary from computer-calculated predictions and should be taken in accordance with IESNA RP-6-15.

Electrical System Requirements: Refer to Amperage Draw Chart and/or the "Musco Control System Summary" for electrical sizing.

Installation Requirements: Results assume ± 3% nominal voltage at line side of the driver and structures located within 3 feet (1m) of design locations.

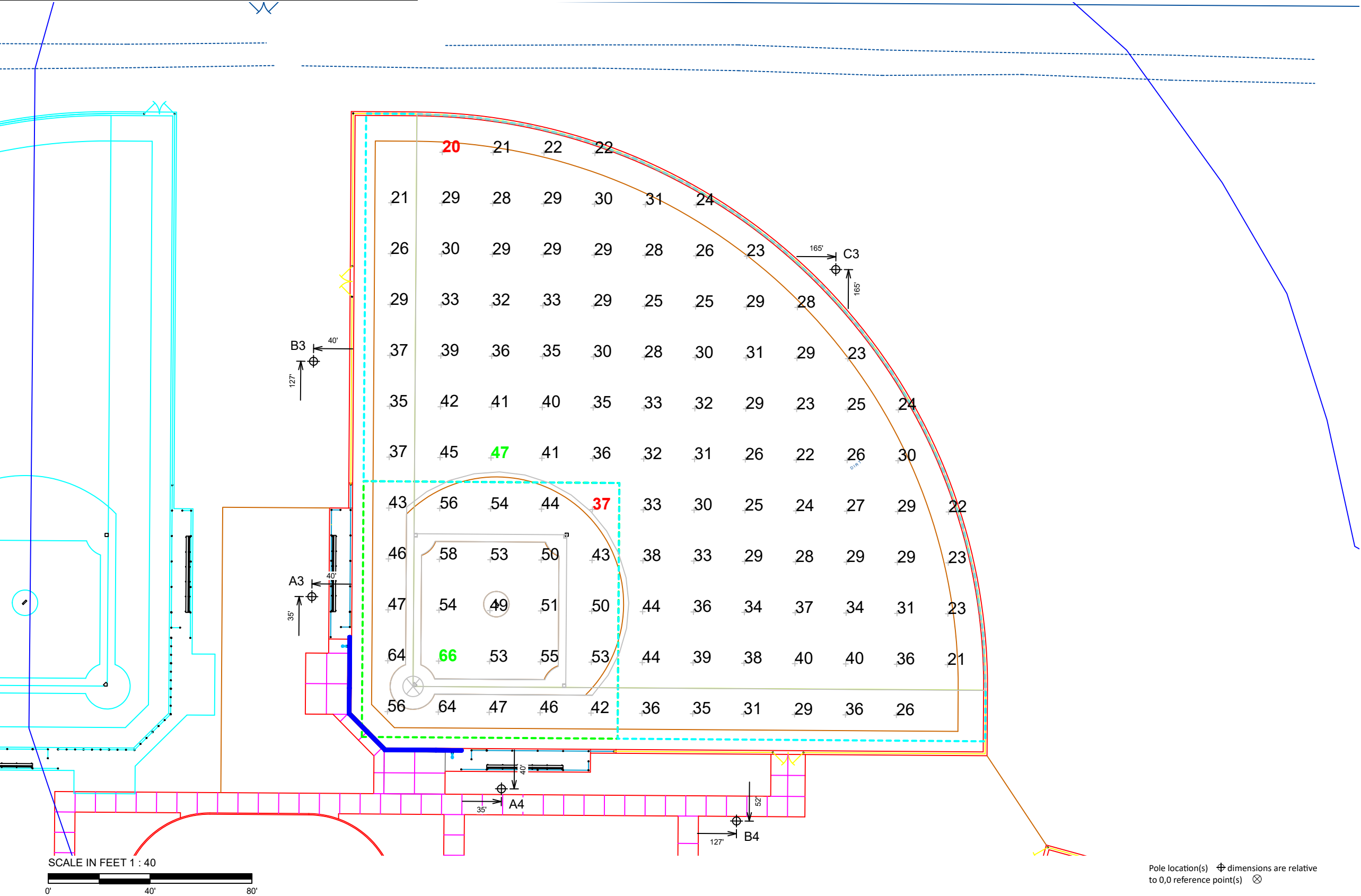

We Make It Happen.

Not to be reproduced in whole or part without the written consent of Musco Sports Lighting, LLC. ©1981, 2021 Musco Sports Lighting, LLC.

ILLUMINATION SUMMARY

EQUIPMENT LIST FOR AREAS SHOWN							
Pole				Luminaires			
QTY	LOCATION	SIZE	GRADE ELEVATION	MOUNTING HEIGHT	LUMINAIRE TYPE	QTY / POLE	THIS GRID
2	A1-A2	60'	-	15.5'	TLC-BT-575	1	1
				60'	TLC-LED-1200	2	2
2	B1-B2	70'	-	15.5'	TLC-BT-575	1	1
				70'	TLC-LED-1500	6	6
2	C1-C2	60'	-	15.5'	TLC-BT-575	2	2
				60'	TLC-LED-1200	4	4
6	TOTALS					32	32
							0

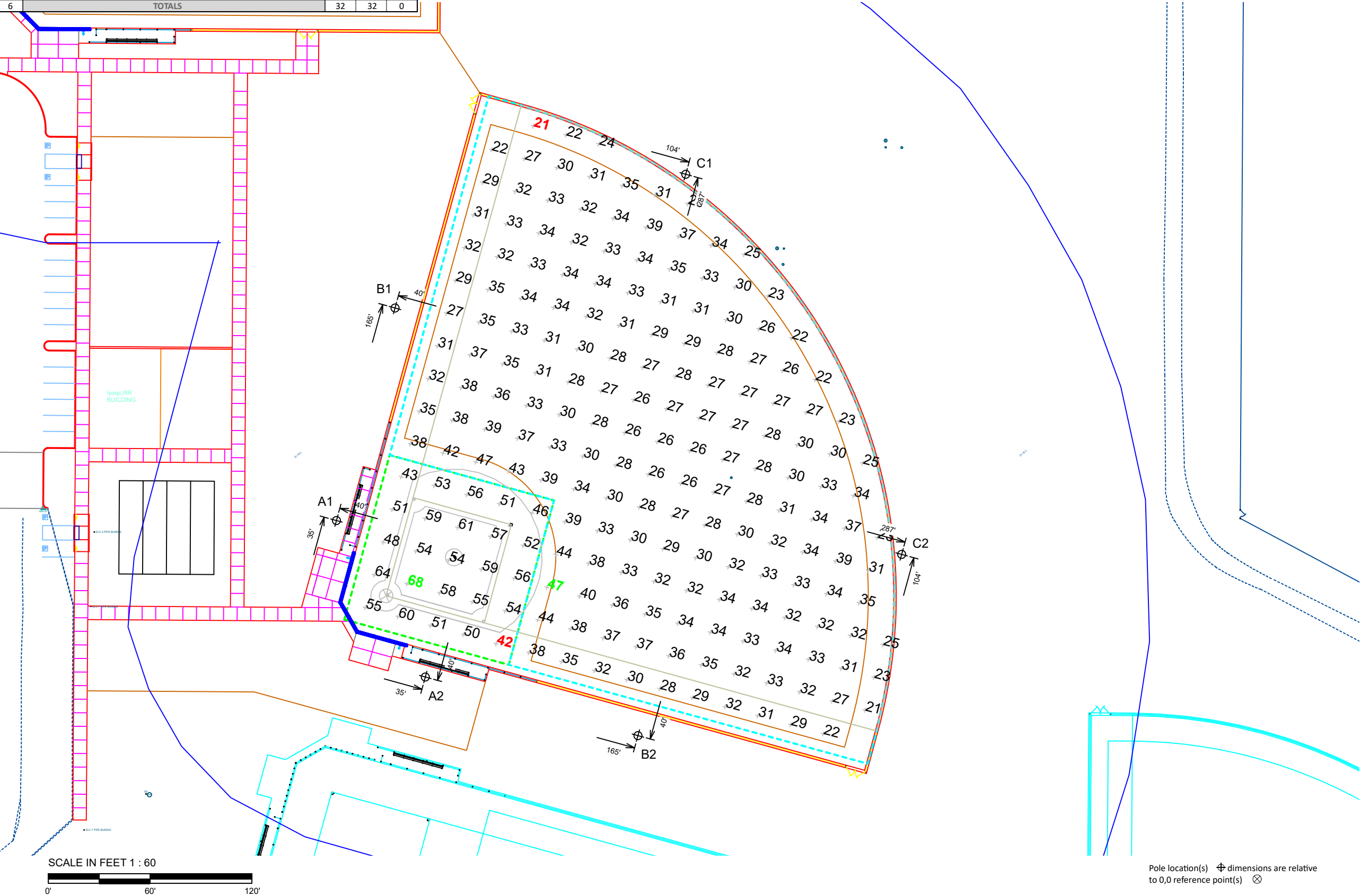

Coalinga-Huron Sports Complex

Coalinga, CA

GRID SUMMARY	
Name:	Field 1
Size:	300'/300'/300' - basepath 60'
Spacing:	20.0' x 20.0'
Height:	3.0' above grade

ILLUMINATION SUMMARY		
MAINTAINED HORIZONTAL FOOTCANDLES		
	Infield	Outfield
Guaranteed Average:	50	30
Scan Average:	54.26	31.45
Maximum:	68	47
Minimum:	42	21
Avg / Min:	1.29	1.49
Guaranteed Max / Min:	2	2.5
Max / Min:	1.61	2.23
UG (adjacent pts):	1.32	1.60
CU:	0.72	
No. of Points:	25	176
LUMINAIRE INFORMATION		
Applied Circuits:	A	
No. of Luminaires:	32	
Total Load:	36.04 kW	

Guaranteed Performance: The ILLUMINATION described above is guaranteed per your Musco Warranty document and includes a 0.95 dirt depreciation factor.

Field Measurements: Individual field measurements may vary from computer-calculated predictions and should be taken in accordance with IESNA RP-6-15.

Electrical System Requirements: Refer to Amperage Draw Chart and/or the "Musco Control System Summary" for electrical sizing.

Installation Requirements: Results assume ± 3% nominal voltage at line side of the driver and structures located within 3 feet (1m) of design locations.



We Make It Happen®

Not to be reproduced in whole or part without the written consent of Musco Sports Lighting, LLC. ©1981, 2021 Musco Sports Lighting, LLC.

ILLUMINATION SUMMARY

EQUIPMENT LIST FOR AREAS SHOWN							
Pole				Luminaires			
QTY	LOCATION	SIZE	GRADE ELEVATION	MOUNTING HEIGHT	LUMINAIRE TYPE	QTY / POLE	THIS GRID
2	A1-A2	60'	-	15.5'	TLC-BT-575	1	1
				60'	TLC-LED-1200	2	2
2	A3-A4	60'	-	60'	TLC-LED-1200	2	2
2	B1-B2	70'	-	15.5'	TLC-BT-575	1	1
				70'	TLC-LED-1500	6	6
2	B3-B4	60'	-	15.5'	TLC-BT-575	1	1
				60'	TLC-LED-1500	4	4
2	C1-C2	60'	-	15.5'	TLC-BT-575	2	2
				60'	TLC-LED-1200	4	4
1	C3	60'	-	15.5'	TLC-BT-575	3	3
				60'	TLC-LED-1200	3	3
11	TOTALS					52	52

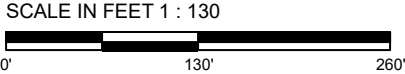
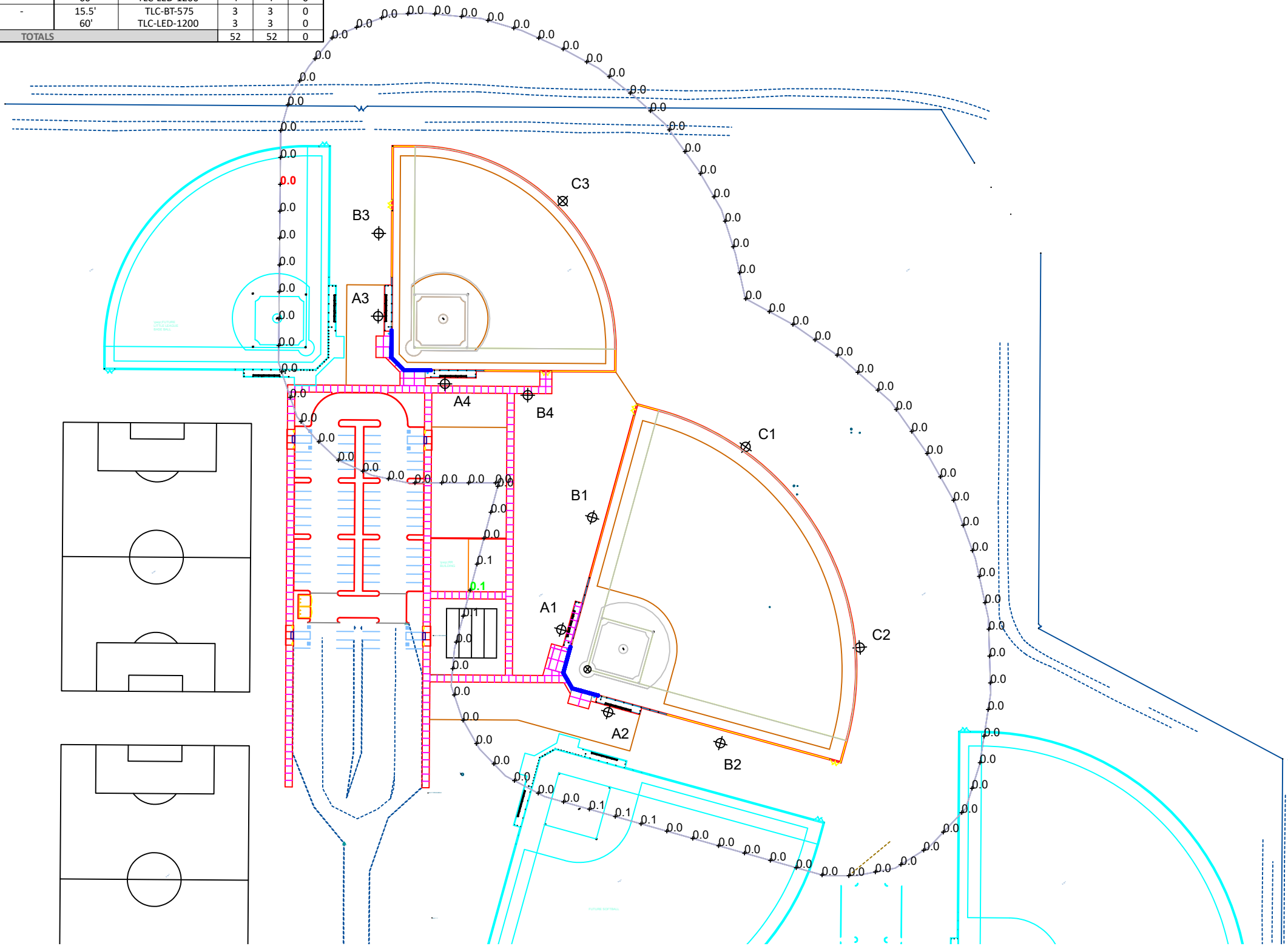

Pole location(s) ⦿ dimensions are relative to 0,0 reference point(s) ⊗

Coalinga-Huron Sports Complex

Coalinga, CA

GRID SUMMARY	
Name:	Spill @ 150'
Spacing:	30.0'
Height:	3.0' above grade

ILLUMINATION SUMMARY	
HORIZONTAL FOOTCANDLES	
Scan Average:	Entire Grid 0.0160
Maximum:	0.12
Minimum:	0.00
No. of Points:	98
LUMINAIRE INFORMATION	
Applied Circuits:	A, B
No. of Luminaires:	52
Total Load:	59.32 kW

Guaranteed Performance: The ILLUMINATION described above is guaranteed per your Musco Warranty document.

Field Measurements: Individual field measurements may vary from computer-calculated predictions and should be taken in accordance with IESNA RP-6-15.

Electrical System Requirements: Refer to Amperage Draw Chart and/or the "Musco Control System Summary" for electrical sizing.

Installation Requirements: Results assume ± 3% nominal voltage at line side of the driver and structures located within 3 feet (1m) of design locations.



We Make It Happen.®

Not to be reproduced in whole or part without the written consent of Musco Sports Lighting, LLC. ©1981, 2021 Musco Sports Lighting, LLC.

ILLUMINATION SUMMARY

EQUIPMENT LIST FOR AREAS SHOWN							
Pole				Luminaires			
QTY	LOCATION	SIZE	GRADE ELEVATION	MOUNTING HEIGHT	LUMINAIRE TYPE	QTY / POLE	THIS GRID
2	A1-A2	60'	-	15.5'	TLC-BT-575	1	1
				60'	TLC-LED-1200	2	2
2	A3-A4	60'	-	60'	TLC-LED-1200	2	2
2	B1-B2	70'	-	15.5'	TLC-BT-575	1	1
				70'	TLC-LED-1500	6	6
2	B3-B4	60'	-	15.5'	TLC-BT-575	1	1
				60'	TLC-LED-1500	4	4
2	C1-C2	60'	-	15.5'	TLC-BT-575	2	2
				60'	TLC-LED-1200	4	4
1	C3	60'	-	15.5'	TLC-BT-575	3	3
				60'	TLC-LED-1200	3	3
11	TOTALS					52	52

Coalinga-Huron Sports Complex
Coalinga, CA

GRID SUMMARY	
Name:	Spill @ 150'
Spacing:	30.0'
Height:	3.0' above grade

ILLUMINATION SUMMARY	
MAX VERTICAL FOOTCANDLES	
Scan Average:	Entire Grid 0.0487
Maximum:	0.29
Minimum:	0.00
No. of Points:	98
LUMINAIRE INFORMATION	
Applied Circuits:	A, B
No. of Luminaires:	52
Total Load:	59.32 kW

Guaranteed Performance: The ILLUMINATION described above is guaranteed per your Musco Warranty document.

Field Measurements: Individual field measurements may vary from computer-calculated predictions and should be taken in accordance with IESNA RP-6-15.

Electrical System Requirements: Refer to Amperage Draw Chart and/or the "Musco Control System Summary" for electrical sizing.

Installation Requirements: Results assume ± 3% nominal voltage at line side of the driver and structures located within 3 feet (1m) of design locations.

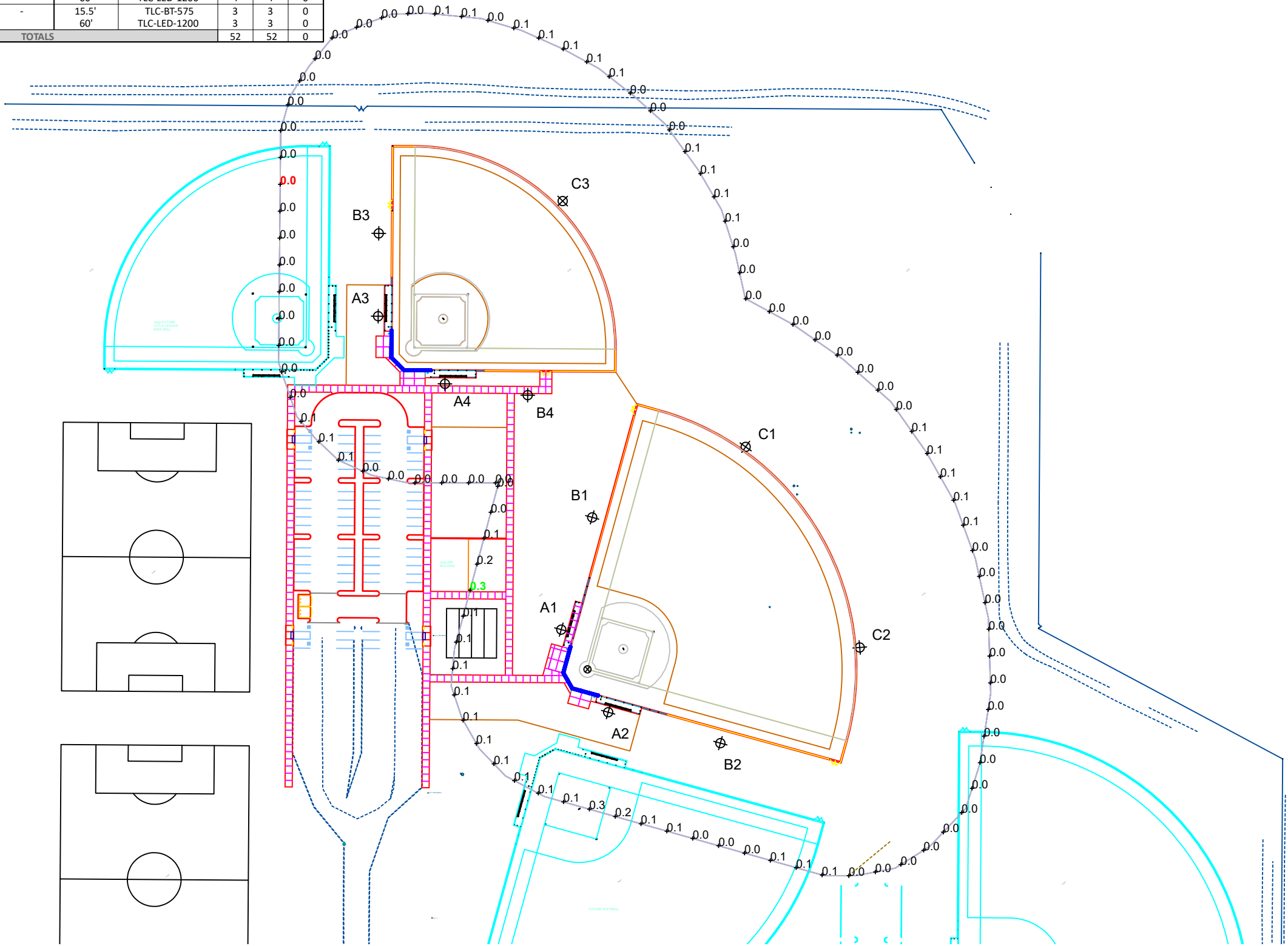

Pole location(s) ⚡ dimensions are relative to 0,0 reference point(s) ⊗



We Make It Happen.®

Not to be reproduced in whole or part without the written consent of Musco Sports Lighting, LLC. ©1981, 2021 Musco Sports Lighting, LLC.

ILLUMINATION SUMMARY

EQUIPMENT LIST FOR AREAS SHOWN							
Pole				Luminaires			
QTY	LOCATION	SIZE	GRADE ELEVATION	MOUNTING HEIGHT	LUMINAIRE TYPE	QTY / POLE	THIS GRID
2	A1-A2	60'	-	15.5'	TLC-BT-575	1	1
				60'	TLC-LED-1200	2	2
2	A3-A4	60'	-	60'	TLC-LED-1200	2	2
2	B1-B2	70'	-	15.5'	TLC-BT-575	1	1
				70'	TLC-LED-1500	6	6
2	B3-B4	60'	-	15.5'	TLC-BT-575	1	1
				60'	TLC-LED-1500	4	4
2	C1-C2	60'	-	15.5'	TLC-BT-575	2	2
				60'	TLC-LED-1200	4	4
1	C3	60'	-	15.5'	TLC-BT-575	3	3
				60'	TLC-LED-1200	3	3
11	TOTALS					52	52

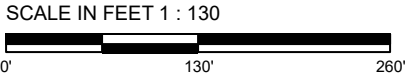
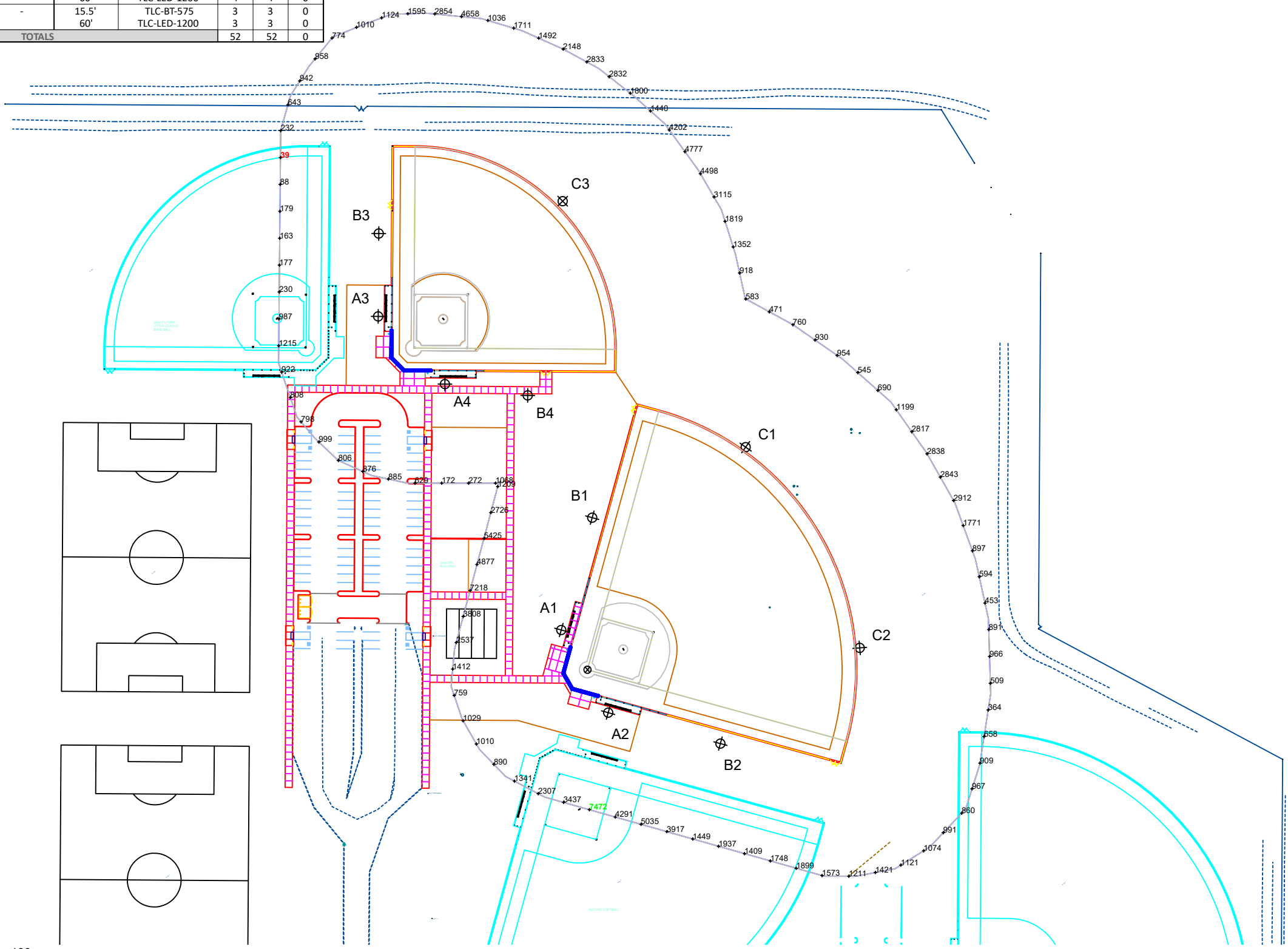

Pole location(s) ⚡ dimensions are relative to 0,0 reference point(s) ⊗

Coalinga-Huron Sports Complex

Coalinga, CA

GRID SUMMARY	
Name:	Spill @ 150'
Spacing:	30.0'
Height:	3.0' above grade

ILLUMINATION SUMMARY	
CANDELA (PER FIXTURE)	
Scan Average:	Entire Grid 1693.7599
Maximum:	7472.46
Minimum:	38.67
No. of Points:	98
LUMINAIRE INFORMATION	
Applied Circuits:	A, B
No. of Luminaires:	52
Total Load:	59.32 kW

Guaranteed Performance: The ILLUMINATION described above is guaranteed per your Musco Warranty document.

Field Measurements: Individual field measurements may vary from computer-calculated predictions and should be taken in accordance with IESNA RP-6-15.

Electrical System Requirements: Refer to Amperage Draw Chart and/or the "Musco Control System Summary" for electrical sizing.

Installation Requirements: Results assume ± 3% nominal voltage at line side of the driver and structures located within 3 feet (1m) of design locations.



We Make It Happen.®

Not to be reproduced in whole or part without the written consent of Musco Sports Lighting, LLC. ©1981, 2021 Musco Sports Lighting, LLC.

ILLUMINATION SUMMARY

EQUIPMENT LAYOUT

INCLUDES:

- Field 1
- Field 2

Electrical System Requirements: Refer to Amperage Draw Chart and/or the "Musco Control System Summary" for electrical sizing.

Installation Requirements: Results assume ± 3% nominal voltage at line side of the driver and structures located within 3 feet (1m) of design locations.

EQUIPMENT LIST FOR AREAS SHOWN						
Pole				Luminaires		
QTY	LOCATION	SIZE	GRADE ELEVATION	MOUNTING HEIGHT	LUMINAIRE TYPE	QTY / POLE
2	A1-A2	60'	-	15.5' 60'	TLC-BT-575 TLC-LED-1200	1 2
2	A3-A4	60'	-	60'	TLC-LED-1200	2
2	B1-B2	70'	-	15.5' 70'	TLC-BT-575 TLC-LED-1500	1 6
2	B3-B4	60'	-	15.5' 60'	TLC-BT-575 TLC-LED-1500	1 4
2	C1-C2	60'	-	15.5' 60'	TLC-BT-575 TLC-LED-1200	2 4
1	C3	60'	-	15.5' 60'	TLC-BT-575 TLC-LED-1200	3 3
11	TOTALS					52

SINGLE LUMINAIRE AMPERAGE DRAW CHART							
Ballast Specifications (.90 min power factor)		Line Amperage Per Luminaire (max draw)					
Single Phase Voltage		208 (60)	220 (60)	240 (60)	277 (60)	347 (60)	480 (60)
TLC-LED-1200		7.0	6.6	6.1	5.2	4.2	3.0
TLC-LED-1500		-	-	-	-	-	4.9
TLC-BT-575		3.4	3.2	2.9	2.5	2.0	1.5



Not to be reproduced in whole or part without the written consent of Musco Sports Lighting, LLC. ©1981, 2021 Musco Sports Lighting, LLC.

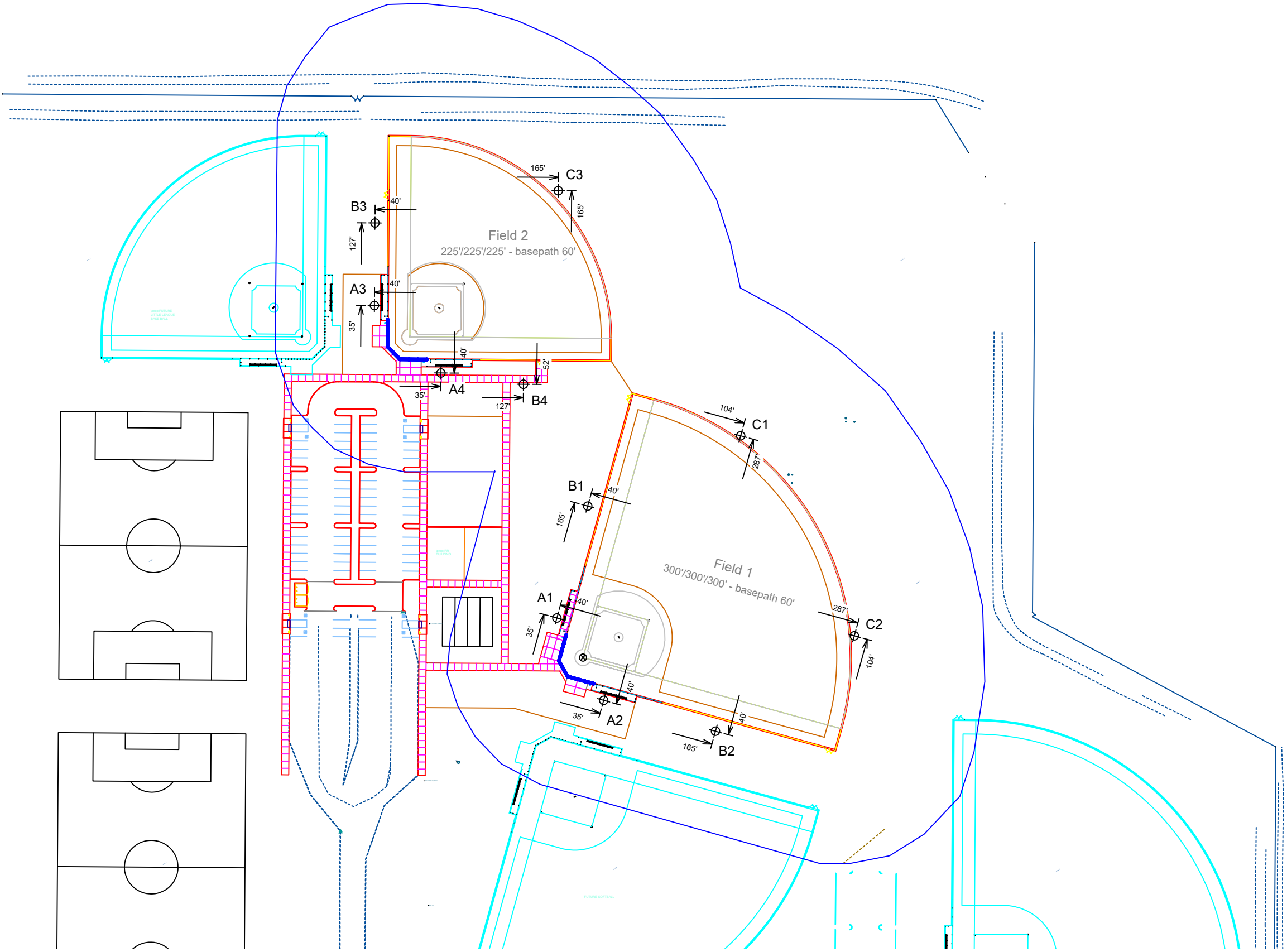

Pole location(s) ⦿ dimensions are relative to 0,0 reference point(s) ⊗