



CARLSBAD
FRESNO
IRVINE
LOS ANGELES
PALM SPRINGS
POINT RICHMOND
RIVERSIDE
ROSEVILLE
SAN LUIS OBISPO

December 23, 2020

Sean Brewer, Assistant City Manager
City of Coalinga
155 West Durian Avenue
Coalinga, CA 93210

Subject: Proposal to Prepare Environmental Review Services for the proposed City of Coalinga Lift Station IS/MND

Dear Mr. Brewer:

LSA Associates, Inc. (LSA) is pleased to submit this proposal to provide environmental review services for the wastewater lift station (proposed project) pursuant to the California Environmental Quality Act (CEQA). In response to your request for a proposal, LSA has developed an approach and work program that provides for a robust environmental review of the project using existing background information as well as work products completed by our technical specialists. Our scope of work includes the following features to ensure that the environmental review process is completed quickly and efficiently:

- Availability of LSA's senior management team, Amy Fischer, Principal, and Kyle Simpson, Associate/Project Manager, who will see the project through from beginning to end;
- Commitment of LSA's in-house experts for key issues of biological resources, cultural resources, air quality, and noise; and
- Ability to work collaboratively with agencies, engineering firms, and the public to communicate effectively with diverse audiences at public forums.

We approach this project with a great deal of enthusiasm and are confident that we have the essential project management capabilities, strategic thinking skills, and experience to efficiently and effectively complete the required environmental review process and to assist staff through the public process. As is always the case with our proposed scope, budget, and schedule, we are open to suggestions for refinement and look forward to discussing with you our approach to this assignment. If you have any questions regarding this proposal, please call Kyle or Amy at 559-490-1210 or e-mail us at kyle.simpson@lsa.net and amy.fischer@lsa.net.

Sincerely,

LSA Associates, Inc.

Amy Fischer
Principal

Kyle Simpson
Associate/Project Manager

PROPOSAL FOR SERVICES

**WASTEWATER LIFT STATION
CITY OF COALINGA**

Submitted to:

Sean Brewer, Assistant City Manager
City of Coalinga
155 West Durian Avenue
Coalinga, CA 93210

Prepared by:

LSA Associates, Inc.
2491 Alluvial Avenue, PMB 626
Clovis, California 93611

559.490.1210



December 2020

TABLE OF CONTENTS

1.	PROPOSED WORK PLAN	1
A.	PROJECT UNDERSTANDING	1
B.	APPROACH	1
C.	SCOPE OF WORK	1
2.	SCHEDULE	11
3.	COST ESTIMATE	13
4.	KEY PERSONNEL AND RELEVANT EXPERIENCE	15
A.	KEY PERSONNEL	15
B.	RELEVANT EXPERIENCE	16

APPENDIX

Team Resumes

TABLES

Table 1: Scope of Work Summary	2
Table 2: Preliminary Schedule	11
Table 3: Cost Estimate for the City of Coalinga Lift Station IS/MND	14

This page intentionally left blank

1. PROPOSED WORK PLAN

The City of Coalinga (City) is seeking an environmental consultant to prepare the environmental review documentation for the Wastewater Lift Station (proposed project), pursuant to the requirements of the California Environmental Quality Act (CEQA). Our understanding of the proposed project is discussed below, followed by our approach to the CEQA review and an outline of the proposed scope of work. A preliminary schedule and cost estimate are included in Chapters 2 and 3 of this proposal, respectively.

A. PROJECT UNDERSTANDING

The City is proposing to construct a lift station to eliminate two wastewater siphons on the north side of Los Gatos Creek to convey wastewater the City's wastewater treatment plant (WWTP). The proposed lift station would be located on a portion of an 83.6-acre site (Assessor's Parcel Number [APN]: 071-020-43S). Although site designs have not be completed, it is anticipated that components of the lift station would include an underground vault/wet well, a force main, portable generator, and aboveground structure with new electrical service. The proposed project would include construction of a new wastewater pipeline connecting the proposed lift station to the City's WWTP under Los Gatos Creek via horizontal directional drilling (HDD). The use of HDD would reduce trenching and limit potential environmental effects.

B. APPROACH

Based on our project understanding, LSA believes that preparation of an Initial Study (IS)/Mitigated Negative Declaration (MND) (or collectively, IS/MND) will be the appropriate environmental document to satisfy the requirements of CEQA. The proposed work program detailed in this proposal reflects this level of effort. It is anticipated that for most environmental issue topics, standard construction-period mitigation measures would be required to reduce potential impacts to a less-than-significant level.

Should the IS analysis identify significant and unmitigable impacts associated with the proposed project, LSA will notify the City and determine an appropriate strategy for addressing these issues per CEQA requirements. This scope is based on the assumption that the project will not result in significant unavoidable environmental impacts and that additional environmental analysis and documentation (beyond an IS/MND) will not be required.

C. SCOPE OF WORK

The scope of work for CEQA compliance and preparation of an IS/MND is discussed below and is summarized in Table 1.

TASK A: PROJECT INITIATION

The project initiation task will provide an opportunity for the LSA team to meet with City staff to collaborate, strategize and discuss LSA's recommended approach to environmental review and the associated work program. Other key project initiation tasks will involve conducting a site visit, gathering information, and preparing the project description.

1. Start-Up and Site Visit

LSA will meet with City staff via videoconference to discuss expectations regarding the tasks to be undertaken as part of the environmental documentation effort for the proposed project. As a part of this meeting, LSA will:

- Discuss the City's expectations and desired approach to environmental documentation for the project;
- Discuss the role of each team member and establish how information will flow within the team;
- Identify any concerns and issues of those in attendance;
- Review information needs and gather any additional relevant information and data; and
- Finalize the schedule for the review process.

2. Data Gathering and Evaluation

Existing data and analyses applicable to the project site and vicinity will be collected, evaluated, and reviewed by the project team. It is assumed that, at a minimum, the City will provide the following project-related materials:

Table 1: Scope of Work Summary

TASK A: PROJECT INITIATION
1. Start-Up and Site Visit
2. Data Gathering and Evaluation
3. Project Description
TASK B: TECHNICAL STUDIES
1. Biological Resources Study
2. Cultural Resources Study
TASK C: EVALUATION OF ENVIRONMENTAL EFFECTS
1. Aesthetics
2. Agriculture and Forestry Resources
3. Air Quality
4. Biological Resources
5. Cultural Resources
6. Energy
7. Geology and Soils
8. Greenhouse Gas Emissions
9. Hazards and Hazardous Materials
10. Hydrology and Water Quality
11. Land Use and Planning
12. Mineral Resources
13. Noise
14. Population and Housing
15. Public Services
16. Recreation
17. Transportation
18. Tribal Cultural Resources
19. Utilities and Service Systems
20. Wildfire
21. Mandatory Findings of Significance
TASK D: INITIAL STUDY
1. Administrative Draft IS/MND
2. Screencheck Draft IS/MND
3. Public Review Draft IS/MND
4. Response to Comments Document
5. Mitigation Monitoring and Reporting Program
TASK E: MEETINGS
TASK F: PROJECT MANAGEMENT

- Written description of the project, including any phases and alternatives;
- Description of construction activities including duration, equipment, and excavation and grading;
- Site plan which includes the following: building footprint; setbacks; vehicle access roadways; and landscaping;
- Conceptual elevations showing height and building appearance of any visible structures;
- Description of pervious/impervious surfaces, both pre- and post-construction; and
- Energy, water conservation, and other green building materials incorporated into the project.

LSA will review the above materials provided by the City, as well as any other additional background reports during the project initiation phase. LSA will also review the City's General Plan and Municipal Code, as well as any other pertinent background documents.

3. Project Description

Based on the City's site plan and elevations and conversations with City staff and the project team, LSA will draft a project description that includes all elements necessary to comply with CEQA, including, but not limited to, the purpose, physical elements and phasing and alternatives of the proposed project. The project description will include a map showing the location and boundaries of the project site. The project description will also describe the overall approval process for the project and identify all discretionary and anticipated subsequent approvals. All relevant agencies and reviewing bodies will also be identified.

Crafting an appropriately detailed and illustrated project description is often the single most time-consuming (as well as important) element of a CEQA review document. LSA will work closely with the City to ensure that the project description provides a level of detail appropriate for CEQA analysis. A draft project description with graphics will be submitted to the City for review and comment before the LSA team begins conducting any impact analyses.

TASK B: TECHNICAL STUDIES

Based on our initial review of the project, a Biological Resources Study and Cultural Resources Study will be needed to adequately address these disciplines under CEQA.

1. Biological Resources Study

LSA proposes to conduct a thorough biological resources assessment required for project review under CEQA and pertinent local, State, and federal regulations. LSA will prepare the assessment by completing the following subtasks:

- **Literature Review and Records Search.** Prior to a site visit, LSA will execute and evaluate a biological resource records search of the most current versions of the California Department of Fish and Wildlife (CDFW) California Natural Diversity Database (CNDDDB), the California Native Plant Society's Electronic Inventory of Rare and Endangered Vascular Plants of California, and the United States Fish and Wildlife Service's (USFWS) Information for Planning and Consultation (iPaC) database. LSA will review the databases for known occurrences of special-status biological resources and mapped jurisdictional aquatic resources. LSA will also review our previous project work in the area for applicable biological resources information. Although LSA is familiar with the biological resources occurring in the vicinity of the subject property, conducting a current records search is a requisite industry-standard procedure.
- **Field Work.** Following the literature review, an experienced LSA biologist familiar with the habitats and special-status natural resources of the region will conduct a general survey of the biological resources in areas that may be directly or indirectly impacted by proposed project development activities (e.g., the Biological Study Area), particularly to document the occurrence of any species or habitats of interest or concern and to determine the potential for the presence of any such resources that may not be detectable at the time of the site survey. All occurrences of rare plant and/or wildlife species on the project site shall be mapped, along with all vegetation communities and other land cover types within the Biological Study Area. LSA anticipates that the general field survey will take one day to complete. While LSA will be prepared to conduct the site survey upon issuance of the notice to proceed with this scope of work, it should be noted that additional appropriately timed surveys may be required to capture the typical blooming periods of regional special-status plant species or activity periods of regional special-status plant species. This scope of work assumes only one reconnaissance-level survey will be conducted, and any additional warranted or required focused surveys would be recommended as project avoidance, minimization, and/or mitigation measures in the technical memorandum described below.

As part of the field work, potential jurisdictional waters of the United States as well as streambeds, riparian vegetation, or wetlands subject to State jurisdiction, and/or features considered sensitive under local ordinances that are identified within the study area would also be assessed in the field. LSA proposes to include information gathered from this field work in the technical memorandum described below. A formal, stand-alone jurisdictional delineation report is not included in this scope, nor is one expected to be required. If a formal jurisdictional delineation report or additional field surveys are requested, LSA will prepare a revised scope and budget to complete those tasks.

- **Biological Resources Technical Memorandum.** Following the field work, LSA will prepare a biological resources technical memorandum describing the results of the literature review and field survey. The report will include:
 - A description of the survey methodology and regulatory background/definitions;
 - A discussion of the of soils, plant communities, and other land cover types;

- Identification and discussion of areas that may potentially be considered jurisdictional wetlands, waters of the U.S., waters of the State, or streambeds, as defined by the U.S. Army Corps of Engineers, California State Water Resources Control Board, and the California Department of Fish and Wildlife ;
- A description of observed or otherwise detected special-status species;
- An assessment of potential habitat value for special-status species and identification of additional focused species surveys that may be necessary (if warranted);
- A discussion of direct, indirect, and cumulative impacts of the proposed project to special-status biological resources;
- A list of plant and wildlife species observed during the survey; and
- Representative photographs of the project site and graphics showing the project location, vegetation communities, and soil types. Additional graphics, as needed, will show locations of special-status species or sensitive natural communities, potential special-status species habitat, and areas of designated critical habitat on or directly adjacent to the project site.

Project-related impacts to biological resources will be evaluated in accordance with the 2020 CEQA Statute and Guidelines and other relevant federal, State, and local regulations/policies. As applicable, measures will be identified for avoidance, minimization, and/or mitigation of project impacts.

- **Requisite Information to be Provided.** LSA will require authorization to enter the project site and a digital vector file (CAD or GIS) of the grading limits, building/structural footprints, landscaping, site drainage elements, and any other ground/vegetation disturbance areas associated with the project. The digital file needs to be in a real-world coordinate system, such as Stateplane Zone 4, NAD83, Survey Feet, to accurately quantify project-related impacts.

2. Cultural Resources Study

LSA's cultural resources study for the project will be conducted in accordance with the requirements of CEQA and will consist of background research, a pedestrian field survey of portions of the project site, and preparation of a brief letter report documenting the findings. Each subtask is described in greater detail below.

- **Background Research – Records Search.** LSA will conduct a cultural resources records search at the Southern San Joaquin Valley Information Center (SSJVIC) of the Californian Historical Resources Information System (CHRIS) located at California State University, Bakersfield. The SSJVIC, an affiliate of the California Office of Historic Preservation (OHP), is the official repository of cultural resources reports and records for Fresno County. The records search will identify recorded cultural resources and studies in and within 0.5 miles of the project site.

- **Background Research – Inventory and Directory Review.** Cultural resource inventories will be reviewed to determine if any cultural resources are listed within or adjacent to the project site. Local county listings and historic aerial photographs, if available, will also be reviewed.
- **Background Research – Native American Heritage Commission.** The Native American Heritage Commission (NAHC) will be contacted to request a search of the Sacred Lands File for any information about cultural resources of traditional or cultural value to tribal organizations, regardless of archaeological value, in or adjacent to the project site.
- **Pedestrian Field Survey.** An LSA archaeologist will conduct a pedestrian field survey of the project site. This scope assumes that no cultural resources will be identified during the survey. If resources are identified, LSA will contact you immediately to develop a scope and budget for additional tasks. For example, cultural resources would be recorded on State of California Department of Parks and Recreation (DPR) Series 523 forms in accordance with the guidelines established by the State Office of Historic Preservation (OHP).
- **Report.** LSA will prepare a letter report to document the cultural resources study methods, results, and management recommendations. The report will be submitted to the SSJVIC in fulfillment of a requirement to access their archives.

TASK C: EVALUATION OF ENVIRONMENTAL EFFECTS

An IS/MND will be prepared in accordance with CEQA and will utilize the Environmental Checklist Form (Appendix G of the CEQA Guidelines). LSA will respond to the checklist questions for the various impact topics and add concise explanatory comments related to each topic. If applicable, the City's standard conditions of approval and existing regulations will be applied wherever possible. This scope of work assumes that upon completion of the IS, a recommendation will be made that an MND will satisfy CEQA documentation requirements. Preparation of an Environmental Impact Report is not included in this scope of work.

The following environmental topics will be evaluated in the IS/MND, consistent with the requirements of CEQA. Each issue topic is shown in alphabetical order, as it appears in the CEQA checklist.

LSA will review any available information pertaining to the proposed project in preparing the environmental checklist responses for the relevant topics in order to demonstrate that no significant effects related to these topics would result from the project. Should additional analysis be necessary, LSA will coordinate with the City to determine next steps.

The following environmental topics will be evaluated in the IS/MND, consistent with the requirements of CEQA.

- | | |
|---------------------------------------|-----------------------------------|
| 1. Aesthetics | 12. Mineral Resources |
| 2. Agriculture and Forestry Resources | 13. Noise |
| 3. Air Quality | 14. Population and Housing |
| 4. Biological Resources | 15. Public Services |
| 5. Cultural Resources | 16. Recreation |
| 6. Energy | 17. Transportation |
| 7. Geology and Soils | 18. Tribal Cultural Resources |
| 8. Greenhouse Gas Emissions | 19. Utilities and Service Systems |
| 9. Hazards and Hazardous Materials | 20. Wildfire |
| 10. Hydrology and Water Quality | 21. Mandatory Findings |
| 11. Land Use and Planning | |

In addition to the topics listed above, please note the following identified environmental topics will include detailed technical analyses:

- **Air Quality and Greenhouse Gas Emissions.** LSA will prepare the air quality impacts analysis for the proposed project based on the latest version of the San Joaquin Valley Air Pollution Control District's (SJVAPCD) *Guide For Assessing and Mitigating Air Quality Impacts*. The air quality analysis will include the following components: 1) assessment of project consistency with the SJVAPCD's air quality attainment plans; 2) quantitative assessment of project construction impacts using the California Emissions Estimator Model (CalEEMod); 3) qualitative discussion of long-term operations and the potential for air emissions associated with the project; and 4) recommendation of mitigation measures consistent with SJVAPCD guidelines. The City should provide all applicable project construction data to LSA, including all anticipated off-road vehicle use and any haul trip rates during construction. Model output will be attached as a technical appendix.
- **Biological Resources.** Using available data and the information gathered for the Biological Resources Study under Task B, LSA will incorporate the responses to the biological resources questions within the IS Checklist. Mitigation measures will be identified, as needed, to reduce any impacts to less-than-significant levels, if feasible.
- **Cultural Resources.** LSA will provide responses to the cultural resources questions within the IS Checklist using the findings identified in the Cultural Resources Study prepared under Task B. It is assumed that the City will be responsible for fulfilling the requirements of Assembly Bill (AB) 52 by initiating consultation with interested Native American tribes.

- **Noise.** LSA will prepare a noise analysis for the proposed project in response to the IS Checklist questions. The noise analysis will include the following components: (1) a description of existing noise conditions in and around the project site; (2) quantitative assessment of noise impacts on sensitive receptors related to project construction and operation; and if required, (3) preparation of mitigation measures consistent with best practices.

TASK D: INITIAL STUDY

LSA will prepare three drafts of the IS/MND: an Administrative Draft, a Screencheck Draft, and a Public Review Draft. The IS/MND will include responses to public comments presented in a memorandum format, as necessary, and a Mitigation Monitoring and Reporting Program (MMRP), as described below.

1. Administrative Draft IS/MND

Using the setting and analysis prepared under Task C above, LSA will prepare an Administrative Draft IS/MND with the following components. Figures and tables will be provided as appropriate to illustrate the project site, the proposed project and the study's findings.

- Project Description
- CEQA Environmental Checklist Form
- Mandatory Findings of Significance
- Contacts and Bibliography
- Technical Appendices
- Mitigated Negative Declaration

The Administrative Draft (IS/MND) will be provided to the City for review and comment. It is assumed that the City will review and consolidate all internal comments before they are submitted to LSA. LSA will provide one electronic version in MS Word and PDF formats for review by City staff.

2. Screencheck Draft IS/MND

Based on a single set of consolidated and non-contradictory comments from City staff, LSA will amend the Administrative Draft IS/MND and will prepare a Screencheck Draft IS/MND for review. We have allotted time for responding to changes; however, if this task exceeds the cost allotted in the budget due to changes in project description or requests for additional analysis that are not necessary to prepare a legally-adequate document, a budget adjustment may be required.

LSA will provide one electronic version in MS Word and PDF formats for review by City staff to verify that all requested changes have been made and all appendix materials, references, and final graphics are acceptable. LSA will also provide the City with an electronic compare version of the Screencheck Draft. This version will show text changes made to the Administrative Draft IS/MND in

underline and strikeout for the City to more easily confirm that all comments and edits are fully incorporated into the Screencheck Draft.

3. Public Review Draft IS/MND

LSA will make any minor necessary revisions to the Screencheck Draft and prepare the public review IS/MND. One copy of the document in MS Word format and PDF format will be prepared. LSA will also prepare a Notice of Completion (NOC), in accordance with the CEQA Guidelines. The City will be responsible for local distribution and noticing pursuant to CEQA and City review procedures.

4. Response to Comments Document

Following a 20- or 30-day public review period, LSA will review public and agency comments received on the Public Review IS/MND, and will prepare responses to CEQA comments in a memorandum format, as necessary. This scope and budget assume up to approximately 10 hours to prepare responses to comments. Should an unexpectedly large volume of comments be submitted, LSA will request an adjustment in the budget to cover work beyond the assumed level. LSA will provide one electronic version in MS Word and PDF format for review by City staff. LSA will prepare a final draft of the response to comments memorandum in response to a consolidated and non-contradictory set of comments from City staff.

5. Mitigation Monitoring and Reporting Program

LSA will prepare a Mitigation Monitoring and Reporting Program (MMRP) for all mitigation measures identified in the IS/MND. The MMRP will list mitigation measures that are recommended in the IS/MND and provide standards and timelines for monitoring these measures. Electronic copies of the final MMRP will be submitted to the City with the Response to Comments memorandum.

TASK E: MEETINGS

Amy Fischer and Kyle Simpson will be available throughout the environmental review period to meet with the City to gather information, review progress, review preliminary findings, discuss staff comments, offer input into discussions on project modifications, and consult on CEQA procedural matters. The cost estimate includes attendance by Amy and/or Kyle at the following meetings: project start-up meeting under Task A, and up to three teleconferences of approximately one hour. If requested by the City, LSA's attendance at additional meetings and/or public hearings would be billed on a time and materials basis.

TASK F: PROJECT MANAGEMENT

Amy and Kyle will undertake a variety of general project management tasks throughout the IS/MND preparation period. Amy will provide input on the scope, budget, contract negotiations and management, and scheduling of the project, and will be responsible for the overall quality of all work undertaken. She will also be available for consultation on CEQA procedural matters as well as application of the CEQA Guidelines to this project.

Kyle will coordinate the day-to-day activities associated with the project. This will include regular client contact, oversight of team members, schedule coordination, and development of products. He

will also provide direction to all team members that will ensure an internally-consistent, coherent document. Amy and Kyle will review all in-house prepared text, tables, and graphics before these materials are presented to the City as administrative review documents.

2. SCHEDULE

The preliminary work schedule for preparation and completion of the environmental review process is shown in Table 2. LSA will finalize the schedule, including deliverable dates with the City once we are authorized to proceed and once preliminary development plans and all requested background materials listed in this scope of work are provided by the City. Please note that this preliminary timeline is aggressive, yet flexible, and we are happy to work with the City to adapt the schedule to fit ongoing priorities and scheduling.

Table 2: Preliminary Schedule

Milestone	Responsible Party	Weeks to Complete	Cumulative Weeks
Notice to Proceed	City	–	–
Project Start-Up Meeting	City/LSA	1	1
Draft Project Description ^a	LSA	2	3
City Review of Draft Project Description	City	2	5
Prepare Administrative Draft IS/MND and Technical Studies	LSA	6	11
Review Administrative Draft IS/MND and Technical Studies	City	3	14
Prepare Screencheck Draft IS/MND	LSA	2	16
Review Screencheck Draft IS/MND	City	2	18
Prepare and Publish Public Review Draft IS/MND	LSA	1	19
<i>30-Day Comment Period</i>	–	30 days	23
Prepare Admin. Draft Response to Comments Memo and MMRP	LSA	1	24
Review Admin. Draft Response to Comments Memo and MMRP	City	1	25
Prepare and Distribute Final Response to Comments and MMRP	LSA	1	26
MND Adoption	City	>10 days	28

^a Assumes that all requested project information and materials received within 1 day of start-up meeting

This page intentionally left blank

3. COST ESTIMATE

For completion of the proposed scope of services within the schedule set forth in this proposal, the LSA team has provided a preliminary cost estimate in the form of a spreadsheet that details tasks by assigned personnel (see Table 3).

The estimated cost of the LSA team's labor and direct expenses is \$34,860. We have also identified a contingency amount of 5 percent of the total budget (\$1,700). The amount would not be used without written authorization from the City. With the contingency amount the total contract would be \$36,560. As you review the proposal and compare the work scope with the line item budget, if you find that there are ways of economizing or believe that expansions are needed, we would be glad to discuss suggestions for modifying both scope and budget.

Table 3: Cost Estimate for the City of Coalinga Lift Station IS/MND

LABOR COSTS									
	Principal (Fischer)	Project Manager (Simpson)	Senior Planner (Carlucci)	Senior Biologist (Gould)	Assistant Biologist and GIS (McDonald)	Cultural Resources, Principal (Sample)	Senior Cultural Resources Manager (Collison)	Document Management, Graphics, and Production (Staff)	Team Total
	Hourly Rate:	\$240	\$165	\$125	\$160	\$100	\$200	\$135	
Task A. Project Initiation									
(1) Start-Up Meetings/Site Visit	2	2							\$810
(2) Data Gathering and Evaluation	1	2							\$570
(3) Project Description	2	6	6					5	\$2,845
Subtotal for Task A	5	10	6	0	0	0	0	5	\$4,225
Task B. Technical Studies									
(1) Biological Resources Study	1	2		8	26			2	\$4,700
(2) Cultural Resources Study	1	2			5	1	18	2	\$3,950
Subtotal for Task B	2	4	0	8	31	1	18	4	\$8,650
Task C. Conduct Environmental Analysis									
Subtotal for Task C	4	6	57	0	0	0	0	0	\$9,075
Task D. Prepare Initial Study/Mitigated Negative Declaration									
(1) Administrative Draft IS/MND	2	6	2					6	\$2,470
(2) Screencheck IS/MND	2	4	4					3	\$2,015
(3) Public Review Draft IS/MND	2	2	4					6	\$2,060
(4) Response to Comments Document	2	4	4					2	\$1,890
(5) Mitigation Monitoring and Reporting Program	1	1	2					1	\$780
Subtotal for Task D	9	17	16	0	0	0	0	18	\$9,215
Task E. Meetings									
Subtotal for Task E	3	3	0	0	0	0	0	0	\$1,215
Task F. Project Management									
Subtotal for Task F	2	8	0	0	0	0	0	0	\$1,800
TOTAL LABOR	25	48	79	8	31	1	18	27	\$34,180
DIRECT COSTS									
(1) Travel, Deliveries, Communication									\$150
(2) Maps; Plans; Reports; Database Searches									\$530
TOTAL DIRECT COSTS									\$680
TOTAL LSA TEAM BUDGET									
TOTAL LSA TEAM BUDGET (WITHOUT CONTINGENCY)								\$34,860	
CONTINGENCY FUNDS									
CONTINGENCY AT 5 PERCENT								\$1,700	
TOTAL LSA TEAM BUDGET WITH CONTINGENCY									
TOTAL LSA TEAM BUDGET (WITH CONTINGENCY)								\$36,560	

4. KEY PERSONNEL AND RELEVANT EXPERIENCE

LSA can accomplish the scope of work using in-house specialists. LSA will have sole responsibility for project management and document preparation, preparation of all environmental analysis and will attend all public hearings. Resumes for key personnel are included in the Appendix to this proposal.

LSA provides multi-disciplinary land use and environmental planning services. As planners and environmental analysts, we are active in all aspects of community development, land use planning, and public involvement, and are adept at helping clients navigate sometimes-complex environmental review processes. As technical specialists, we provide expertise in air quality, greenhouse gas emissions, noise, biological resources, water quality, cultural resources, and transportation and parking. Environmental analysis has been the cornerstone of LSA's professional practice since our founding in 1976 and continues as one of the firm's key practice areas. Our understanding of both development planning and the public interest results in realistic and fair recommendations. We offer efficient and responsive support to State, regional, and local government, private sector, and institutional clients.

A. KEY PERSONNEL

This project will be managed from LSA's Fresno office. Key LSA personnel that will manage and contribute to the CEQA analysis are identified below.

*Kyle Simpson, Associate, is LSA's designated **Project Manager**.*

Mr. Simpson is a CEQA and NEPA practitioner and project manager with 10 years of experience. He has served as project manager or key staff on over 40 projects in Northern California and the Central Valley. He has extensive experience with project-level analysis for mixed use development, school facilities, public facilities, and open space/recreational facilities. His responsibilities at LSA include project management and preparation of CEQA/NEPA documents. Mr. Simpson will be in charge of day-to-day activities associated with the project. Project management tasks include regular client contact; contract negotiation and management; oversight of team members; schedule coordination; and development of products. Mr. Simpson will provide direction to all team members that will ensure an internally-consistent, coherent document. He will also review all text, tables, and graphics before these materials are presented to the City of Coalinga as administrative review documents. Mr. Simpson is currently involved with several CEQA and environmental planning assignments, including the Costco technical studies for the City of Clovis, 2695 W. Winton Project IS/MND Project CEQA for the City of Hayward, and the Livermore Active Transportation Plan CEQA for the City of Livermore.

Amy Fischer, Principal, will serve as *Principal-In-Charge* and direct the air quality, noise, and greenhouse gas emissions analysis.

As Principal-in-Charge, Ms. Fischer will ultimately be responsible for timely response and quality assurance of project work and will also ensure that staff resources are available and properly allocated for all work assignments. She will provide input on scope, budget, and scheduling of the project, and quality assurance for all work undertaken. Ms. Fischer will strategize and work closely with Kyle Simpson to craft the project description on which the environmental analysis will be based. Ms. Fischer has 19 years of experience in the environmental field and has participated in environmental analysis for many diverse projects in California. Her air quality analysis experience includes permitting with the air pollution control districts throughout California, and other regulatory agencies. She also conducts health risk assessments under the latest guidelines for both construction and project operations. Ms. Fischer has recently managed CEQA documents for the cities of Porterville, Clovis and Fremont, and the Madera Irrigation District. She is the Managing Principal of LSA's Fresno office.

Cara Carlucci, Senior Planner, will serve as the project planner and will prepare both technical and non-technical sections of the environmental analysis.

Ms. Carlucci has provided support for the preparation of several CEQA analyses for projects including the Summit Estates Two Subdivision Project IS/MND for the City of Porterville; Landfill Left Turn Lane IS/MND for the City of Clovis; and the Costco technical studies for the City of Clovis. She has contributed to the air quality and global climate change analyses for several California High Speed Rail environmental documents for segments in Fresno, Kern, and Los Angeles counties.

B. RELEVANT EXPERIENCE

We have opted to summarize a diversity of CEQA and technical experience to demonstrate the range of LSA's experience.

Wastewater Treatment Plants IS/MND for the City of Lemoore. The project includes the construction of two new wastewater treatment plants (WTPs) at two existing well sites, Well Site 7 and Well Site 11, to comply with a California Department of Drinking Water (DDW) compliance order. Well Site 7 is located on the west side of the City along Bush Street across the street from West Hills College, and Well Site 11 is located on the north side of the City at the northeast corner of the intersection of Glendale Avenue and 18th Avenue. LSA prepared an IS/MND to address potential environmental effects resulting from the construction and operation of both WTPs. Issues of concern included potential impacts to nesting birds, and temporary construction-related air quality and noise impacts.

On-Call CEQA Services for the City of Porterville. Since 2012, LSA has held an on-call environmental services contract with the City of Porterville. The City is in the midst of a significant number of public and private improvement projects and sought the assistance of LSA to prepare environmental documents and technical studies. To date, LSA has prepared the CEQA documentation, cultural

resources and Phase I (ESA) studies for roadway improvements and residential projects. A representative task is described below:

- Summit Estates IS/MND.** The proposed Summit Estates project consists of the development of 192 detached single-family residential units with average lot sizes of 6,000 square feet on 70 acres. LSA prepared an IS/MND to evaluate the potential environmental impacts. Of the CEQA checklist topics, biology, cultural resources, greenhouse emissions, and noise were of special concern. LSA in-house specialists contributed to the analysis of these issues, enabling the City to conclude that although the proposed project could have a significant effect on the environment, there would not be a significant effect in this case because revisions in the project were made by or agreed to by the project proponent.
- Integrated Master Plan EIR.** The City is preparing an Integrated Master Plan to combine wastewater water and stormwater master plans in comprehensive plan. LSA is evaluating the potential environmental impacts of identified construction projects that would occur in the near-term, as well as program-level analysis of long-term components. LSA's in-house specialists are preparing standalone technical reports related to air quality, biological resources, cultural resources, and noise.

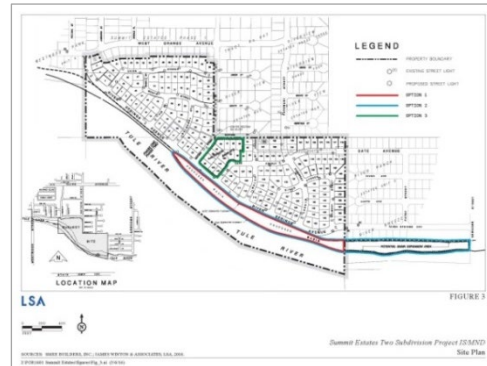

Clovis Costco Technical Studies for the City of Clovis. Costco Wholesale and its project architects propose to construct a 155,000-square-foot warehouse store with a parking lot on a 16-acre parcel in the City of Clovis. The project also includes a fueling station with 20 pumps with potential future expansion to 30 pumps. LSA was asked to prepare an air quality and greenhouse gas impact analysis, biological resources evaluation, and a cultural resources study. The project site is a fallow agricultural field that does not support any natural vegetation communities. A small area in the southeast corner of the

BSA is used seasonally as a Christmas tree lot. The site is surrounded by paved roads and development on all sides. The cultural resources survey did not identify any cultural resources that meet the definition of a historical or unique archaeological resource under CEQA.

Merced County On-Call Environmental Services, Merced County. LSA was recently retained by the Merced County Department of Public Works to provide specialized professional environmental consulting services. Our role is to assist the County in complying with federal and State environmental laws, regulations and guidelines for transportation related and capital improvement projects. The original contract was issued in 2017 for a 2-year term. For the contract, LSA assembled

a team to provide comprehensive environmental services for the County; DHA is on the team to provide engineering services, and WRECO is on the team to provide water quality, floodplain, and hazardous materials expertise. Over the past year, LSA has been awarded 3 task orders for projects ranging from simple permitting assistance to a full set of environmental technical services to complete CEQA/NEPA for a Highway Safety Improvement Program (HSIP) project.

APPENDIX A

TEAM RESUMES



This page intentionally left blank



EXPERTISE

- CEQA Project Management
- Environmental Planning and Impact Analysis
- Land Use Planning and Development

EDUCATION

B.S., Political Science, Santa Clara University, 2003

PROFESSIONAL EXPERIENCE

Associate, LSA, Fresno, California, 2017–Present

Senior Associate, PlaceWorks, Clovis, California, 2006–2017

PROFESSIONAL AFFILIATIONS

Association of Environmental Professionals (AEP)

PROFESSIONAL RESPONSIBILITIES

Mr. Simpson is a California Environmental Quality Act (CEQA) and National Environmental Policy Act (NEPA) practitioner and project manager with over 14 years of experience. He has served as project manager or key staff on over 40 projects in Northern California and the Central Valley. He has extensive experience with project-level analysis for mixed-use development, school facilities, public facilities, and open space/recreational facilities.

His responsibilities at LSA include project management and preparation of CEQA/NEPA documents and leading major marketing efforts.

PROJECT EXPERIENCE

City of Fresno, General Plan Environmental Impact Report (EIR) Update Fresno, Fresno County, California

Mr. Simpson is currently managing the preparation of the update of the City's General Plan Master EIR to a Program EIR in order for it to be in conformance with State law and to be consistent with recent legislative changes. This update is intended to streamline implementation of the General Plan by supporting the General Plan's programs and projects with updated environmental analysis, regulatory framework, and mitigation measures pursuant to CEQA. Key components include air quality analysis and health risk assessment, updating the City's Greenhouse Gas Reduction Plan, and transportation and Vehicle Miles Traveled (VMT) analyses.

City of Fresno, Standard Forms and Language for CEQA Documents Fresno, Fresno County, California

Mr. Simpson worked closely with City of Fresno staff to develop a comprehensive update to the City's Initial Study template to include standard language and instructions for the preparation of future Initial Studies. Mr. Simpson developed standard language to include as baseline information as well as suggested standard mitigation measures. Mr. Simpson also updated the City's standard Mitigation Monitoring and Reporting Program, and Operations Checklist to allow for streamlined implementation of future projects.

City of Porterville, Eagle Mountain Infrastructure Improvement Project Initial Study/Mitigated Negative Declaration (IS/MND) Porterville, Tulare County, California

Mr. Simpson managed the preparation of an IS/MND that evaluated the potential environmental impacts resulting from the construction of infrastructure required for the relocation of the Eagle Mountain Casino. The project included construction and operation of a 308,000-gallon-per-day Water Reclamation Facility, and wastewater treatment facility improvements, including replacement of 10-inch sewer pipe, lift station pumps, 6-inch force main, and construction and operation of a 200-acre-foot regional retention basin.

City of Porterville, Integrated Master Plan Environmental Impact Report (EIR) City of Porterville, Tulare County, California

Mr. Simpson is currently working with City of Porterville staff to prepare an EIR to evaluate potential environmental impacts from implementation of citywide master plans for the water system, sanitary sewer system, storm drain system, and wastewater treatment facilities. Technical studies required for the EIR include an air quality and greenhouse gas emissions study, biological resources evaluation, and cultural resources study.

**City of Clovis, Dog Park Master Plan Initial Study/Mitigated Negative Declaration (IS/MND)
Clovis, Fresno County, California**

Mr. Simpson managed the preparation of the Dog Park Master Plan IS/MND for the construction and implementation of the citywide Dog Park Master Plan intended to serve as a planning policy document that establishes best practices, design standards, and planning recommendations for a network of potential dog parks. The IS/MND evaluated the potential short-term environmental impacts resulting from construction of the dog parks, as well as potential long-term operational impacts resulting from park usage and maintenance.

**City of Berkeley, 1110 University Avenue Initial Study/Mitigated Negative Declaration and Planning
Services
Berkeley, Alameda County, California**

Mr. Simpson managed the CEQA documentation and provided staff support for a mixed-use project located along a busy thoroughfare. He also prepared the Zoning Adjustments Board staff report, and attended City meetings related to the project.

**City of Livermore, Downtown Specific Plan Amendment CEQA Addendum
Livermore, Alameda County, California**

Mr. Simpson managed the CEQA documentation for a mixed-use project located within the boundaries of the Downtown Specific Plan. Using the Specific Plan EIR, LSA prepared an Addendum to the Final EIR, supported by technical analyses. The proposed project will contain residential and commercial uses.

**City of Livermore, Livermore Bike/Pedestrian Active Transportation Plan
Livermore, Alameda County, California**

Mr. Simpson managed the preparation of the Initial Study/Mitigated Negative Declaration (IS/MND) for the Livermore Bicycle, Pedestrian, and Trails Active Transportation Plan (ATP). The ATP is a program/policy-level document that includes a set of goals, policies, and implementation programs for improving Livermore's bicycle and pedestrian network, and related capital projects to help accomplish the ATP's objectives. Alta Planning + Design prepared the ATP and LSA prepared the IS/MND to evaluate the effects of the ATP at a program level.

**City of Merced, Merced Mall Expansion Project Initial Study/Mitigated Negative Declaration
Merced, Merced County, California**

Mr. Simpson managed the CEQA documentation for the proposed increase of leasable retail area and construction of a new movie theater at one of two possible locations within the project site. To support the CEQA analysis, LSA prepared a standalone Transportation Impact Analysis and a standalone cultural resources study, the results of which will be incorporated into the Initial Study analysis.

**City of Madera, Village D Specific Plan Environmental Impact Report (EIR)
Madera, Madera County, California**

Mr. Simpson is managing a major EIR for the City of Madera that evaluates the development of a new compact mixed-use community that extends the City of Madera's existing urban fabric, creates walkable and bikeable streets, and integrates open space throughout the area east of the City limits. The EIR will analyze how implementation of the Specific Plan could result in environmental impacts, and where applicable, how those potential impacts could be reduced. To do this, both program-level and project-level analyses would be used in the EIR to address potential impacts occurring as specific projects are developed during buildout of the Specific Plan.

**EXPERTISE**

- CEQA/NEPA
- Air Quality Analysis
- GHG Emissions Analysis
- Climate Change Analysis
- Noise Analysis
- Transportation Planning
- Health Risk Assessment

EDUCATION

B.S., Environmental Policy Analysis, minor in Geography
University of Nevada, Reno,
1998

PROFESSIONAL EXPERIENCE

Principal, LSA, Fresno,
California, July 2005–Present

Transportation Planner, VRPA
Technologies, 2002–2005

PROFESSIONAL CERTIFICATIONS

San Joaquin Valley Air
Pollution Control District
Regulation VIII – Certified
Dust Control Plan Preparer,
May 19, 2015

PROFESSIONAL AFFILIATIONS

Association of Environmental
Professionals (AEP) – Director,
Central Valley Chapter, 2016–
Present

AEP – VP of Programs, Central
Valley Chapter, 2011–2015

American Planning
Association (APA)

PROFESSIONAL RESPONSIBILITIES

With 20 years of experience in environmental studies, Ms. Fischer has performed principal-level review or conducted over more than 200 CEQA/NEPA-related and/or stand-alone air quality and greenhouse gas (GHG) impact studies for community plans, development projects, and infrastructure improvements. She is experienced with the models and methods used to assess both air quality and GHG impacts. As the Director of LSA's Air Quality Services, she monitors State and federal standards, case law, and scientific research to make sure that LSA's analyses reflect the rapid changes in this evolving field. In keeping with LSA's commitment to senior-level management, as the Principal in Charge, Ms. Fischer maintains substantive involvement with projects as a means of ensuring high-quality products and balanced professional consultation. She works closely with Project Managers and clients, and provides input on and monitors the scope, budget, and scheduling of specific projects. Ms. Fischer is ultimately responsible for the quality of all project work, and reviews all in-house prepared text, tables, and graphics before these materials are presented to the client.

PROJECT EXPERIENCE**CEQA/NEPA**

Ms. Fischer serves as principal air quality, climate change and noise analyst for CEQA/NEPA and planning documents. She has a comprehensive knowledge of the CEQA requirements for air quality districts throughout California. Her experience is in assessing both plan- and project-level air quality impacts ranging from criteria pollutant analysis to dispersion modeling and health risk assessments using the latest air quality modeling tools. She is skilled in air quality assessment models including the California Emissions Estimator Model (CalEEMod), Emission Factor models (EMFAC/OFFROAD), the Road Construction Estimator Model (RoadMod), and Line Dispersion Models (CALINE). She designs emission reduction strategies to reduce project-specific air quality impacts.

Ms. Fischer recently provided principal-level review for the topical CEQA analyses for the following projects:

- *Air Quality Impact Analysis Land Use and Urban Design Elements*, City of Long Beach, California.
- *Kaiser Permanente Baldwin Park Medical Center Parking Structure Expansion and Medical Office Building MND*, Kaiser Permanente.
- *Air Quality and Greenhouse Gas Analysis for the Operations Center and Site Consolidation Project*, Moulton Niguel Water District.
- *West Alton Parcel Development DEIR Air Quality and Greenhouse Emissions Technical Appendices Peer Review*.

Ms. Fischer also contributed to the *Greenhouse Gas Emissions Reduction Strategy* for the City of Hope Campus Plan. In addition, she served as the primary author of the Air Quality, Greenhouse Gas, and Noise sections of the

San Francisco General Hospital Rebuild Project EIR, as well as the Children's Hospital and Research Center Oakland Campus Master Plan EIR.

GREENHOUSE GAS

Ms. Fischer prepares quantitative GHG analyses that evaluate the impacts of project-related GHG emissions and project impacts related to global climate change. The reports describe the existing setting and regulatory context, quantify impacts, and recommend mitigation measures, as appropriate.

Using CalEEMod (or other local model), Ms. Fischer performs a quantitative assessment of GHG emissions associated with all relevant sources related to the project, including construction activities, new vehicle trips, electricity consumption, water usage, and solid waste generation and disposal. Ms. Fischer recently conducted the GHG analysis for the *4660 Sierra College Boulevard Commercial Project, Rocklin*; the *Thompson and Dakota Residential Project, Clovis*; and the *Balfour Road Shoulder Widening Project, Contra Costa County*. Most recently, she provided the air quality and GHG analysis for a General Plan Amendment, including rezoning and annexation, for the City of Fresno.

HEALTH RISK ASSESSMENTS

The Air Toxics Hot Spots Information and Assessment Act of 1987 seeks to provide information to State and local agencies and to the general public on the extent of airborne emissions from stationary sources and the potential public health impacts of those emissions. Ms. Fischer prepares Health Risk Assessments (HRAs) using the *Guidance Manual* (February 2015) developed by the California Office of Environmental Health Hazard Assessment (OEHHA).

She is trained in the use of the Hot Spots Analysis and Reporting Program (HARP) model, developed by the California Air Resources Board (CARB), as a tool to implement the risk assessments as outlined in the *Guidance Manual*. Ms. Fischer has prepared HRAs for the following projects:

- *211 Airport Boulevard/Pinefino Apartments Project Health Risk Assessment, South San Francisco, CA*, for Concord Design Group.
- *Miramonte Sanitation Transfer Station Project Health Risk Assessment, Reedley, CA*, for Miramonte Sanitation.
- *Redwood Hills Residential Project Health Risk Analysis, Oakland, CA*, for Affordable Housing Associates.
- *Riviera Avenue Residential Project Health Risk Assessment, Walnut Creek, CA*, for Resources for Community Development.
- *1601 Mariposa Mixed-Use Project Air Quality Criteria Pollutant Analysis, San Francisco, CA*, for Related California.
- *Fremont Gateways Health Risk Assessment, Fremont, CA*, for Tim Lewis Communities.

CLIMATE ACTION PLANS/GREENHOUSE GAS STRATEGIES

LSA is currently preparing Climate Action Plans and Greenhouse Gas Reduction Strategy Plans for several agencies. Ms. Fischer serves as Principal in Charge and provides technical oversight for the following projects:

- *Sustainable Santee: The City's Roadmap to Greenhouse Gas Reductions, for the City of Santee*. Update of the City's GHG emissions inventory; forecasts and target setting; development of adaptation strategies. Strategies focus on public health and safety, electrical demand, water availability, infrastructure damage, wildfire, and social equity.
- *Climate Action Plan Update for the City of Corona*. Preparation of GHG Inventory, Forecasting, and Target-Setting Report for a CAP. Inventory describes historic energy use and GHG emissions and forecasts describe projected future emissions. Target-setting recommends GHG reduction measures consistent with State goals.

- *Climate Action Plan 2020 Update for Riverside County.* Assistance with monitoring the implementation of the CAP GHG emission reduction measures to ensure achievement of the 2020 GHG emission reduction target; update of the CAP to provide specific targets for GHG reduction for 2030 and 2050. Development of methodology that the County of Riverside will use to track implementation and effectiveness in reaching GHG reduction goals.
- *Greenhouse Gas Emissions Reduction Strategy for University of California, San Diego (UCSD), Hillcrest Campus Long Range Development Plan.* LSA assisted UCSD in the development of a GHG Reduction Strategy for the Hillcrest medical campus, home to one of the region's oldest and most well-known hospitals. UCSD plans to replace outdated buildings with a new hospital and residential units to meet seismic codes, and bring the entire campus into alignment with UCSD system-wide sustainability policies, as well as the State's GHG reduction goals.

Ms. Fischer directs the GHG analyses that quantify the impacts of project-related GHG emissions and evaluate project impacts related to global climate change. The reports describe the existing setting and regulatory context, quantify impacts, and recommend mitigation measures, as appropriate.

- *City of Hope Campus Plan Greenhouse Gas Emissions Reduction Strategy*, Duarte, California.
- *San Francisco General Hospital Rebuild Project EIR (Air Quality, Greenhouse Gas CEQA Analysis)*, San Francisco, California.
- *Children's Hospital and Research Center Campus Master Plan EIR Air Quality, Greenhouse Gas CEQA Analysis*, Oakland, California.
- *General Plan Amendment, Rezoning, and Annexation Air Quality and Greenhouse Gas Analysis*, Fresno, California.

This page intentionally left blank



EXPERTISE

- CEQA Document Preparation
Environmental Analysis
- Air Quality Analysis
- Greenhouse Gas Emission
Analysis
- Noise Analysis
- Land Use Planning

EDUCATION

B.S., City & Regional Planning,
minor in Real Property
Development, California
Polytechnic State University,
San Luis Obispo, June 2015

PROFESSIONAL EXPERIENCE

Senior Environmental Planner,
LSA, Fresno, California, June
2014–Present

Assistant Planner, San Luis
Ranch, Coastal Community
Builders Pismo Beach,
California, February 2015–
June 2015

Housing Intern, County of San
Luis Obispo, spring 2014

PROFESSIONAL AFFILIATIONS

Association of Environmental
Professionals (AEP) –
Secretary, Central Valley
Chapter, 2016–Present

AEP – Student Liaison, Central
Valley Chapter, 2016–Present

American Planning
Association (APA)

PROFESSIONAL RESPONSIBILITIES

Ms. Carlucci is a Senior Environmental Planner with a growing roster of experience. At LSA, she provides project management and technical assistance on a variety of planning and environmental documents including environmental assessments, initial studies, and environmental impact reports. At LSA, Ms. Carlucci has been involved in residential and commercial development projects, road improvement projects, and program-level plans. Ms. Carlucci has a strong foundation in land use planning and is well versed in addressing impacts to air quality, greenhouse gas emissions, and noise.

Ms. Carlucci is proficient with the use of the Federal Highway Administration Traffic Noise Prediction Model (FHWA RD-77-108) and is proficient in air quality models, including the California Emissions Estimator Model (CalEEMod) and the Roadway Emissions Estimator Model (RoadMod). Ms. Carlucci is also responsible for conducting field noise measurements with the Larson Davis SoundTrack LxT sound level meter in compliance with applicable standards.

PROJECT EXPERIENCE

City of Hanford, Hanford Place Project IS/MND Hanford, Kings County, California

Ms. Carlucci, serving as the Project Manager, prepared both technical and non-technical sections of the Initial Study/Mitigated Negative Declaration (IS/MND) for the proposed project, which would develop a medical and mixed-use development and would construct 15 buildings consisting of medical outpatient clinic services, hotel and conference center, specialized education, retail, medical office, skilled nursing and assisted living, and multifamily residential uses, as well as a bio infiltration basin, associated open space, circulation and parking, and infrastructure improvements.

City of Menlo Park, 111 Independence Drive, Environmental Impact Report Menlo Park, San Mateo County, California

Ms. Carlucci prepared the Air Quality, Greenhouse Gas, and Noise sections of the EIR for the proposed project, which would result in the demolition of existing office space and redevelopment of the project site with an approximately 145,350-gross-square foot (gsf), eight-story multifamily apartment building with approximately 105 dwelling units and an approximately 712-square foot potential commercial space, as well as associated open space, circulation and parking, and infrastructure improvements.

City of Clovis, City of Clovis Fire Station 6 Project Air Quality and Greenhouse Gas Emissions Analysis and Noise Analysis Clovis, Fresno County, California

Ms. Carlucci prepared the air quality, greenhouse gas, and noise analyses for the proposed project, which would construct a 7,943-square foot fire station, a 1,392-square foot dispatch center, a communications tower, and associated parking and landscaping in the City of Clovis.

**City of Santa Ana and Caltrans District 12, Fairview Street Improvements Project
Santa Ana, Orange County, California**

Ms. Carlucci is serving as the Project Manager and prepared both technical and non-technical sections of the Initial Study/Mitigated Negative Declaration (IS/MND) and Categorical Exclusion (CE) for the proposed project, which consists of widening Fairview Street from 9th Street to 16th Street, including replacing the Fairview Street bridge crossing over the Santa Ana River.

ADDITIONAL PROJECT EXPERIENCE

- *Menlo Uptown Project EIR* for the City of Menlo Park.
- *Menlo Portal Project EIR* for the City on Menlo Park.
- *1724 Sunnyhills Court Project IS/MND* for the City and County of San Francisco.
- *600 Addison Project IS/MND* for the City of Milpitas.
- *Maintenance and Operational Facility Project CE* for the Fresno County Rural Transit Agency.
- *500 Turk IS/MND* for the City and County of San Francisco.
- *600 Addison IS/MND* for the City of Berkeley.
- *Fresno General Plan Update EIR* for the City of Fresno.
- *Madera Village D Specific Plan EIR* for the City of Madera.
- *Lemoore Water Treatment Plants Project IS/MND* for the City of Lemoore.
- *Marsh Creek Trail IS/MND* for the East Bay Regional Park District.
- *River View Villas Project MND* for the City of Porterville.
- *San Jose Fire Training Center IS/MND* for the City of San Jose.
- *Seacliff Assisted Living Project IS/MND* for the City of Huntington Beach.
- *1300 Columbus Project IS/MND* for the City and County of San Francisco.
- *Villa/Minnewawa Avenue Widening Project IS/MND* for the City of Clovis.
- *Cypress City Center Project EIR* for the City of Cypress.
- *Tirador Residential Development Project EIR* for City of San Juan Capistrano.
- *San Bruno Recreating and Aquatics Center Project EIR* for the City of San Bruno.
- *Tice Valley Park Lighting Project IS/MND* for the City of Walnut Creek.
- *California High-Speed Rail Project Fresno to Bakersfield Locally Generated Alternative Section Air Quality and Global Climate Change Technical Report and EIR/EIS* for the California High-Speed Rail Authority.
- *California High-Speed Rail Project Bakersfield to Palmdale Section Air Quality and Global Climate Change Technical Report and EIR/EIS* for the California High-Speed Rail Authority.
- *California High-Speed Rail Project Burbank to Los Angeles Section Air Quality and Global Climate Change Technical Report and EIR/EIS* for the California High-Speed Rail Authority.